

# Signature Series

---

**LAMI**  
WOOD PRODUCTS  
CORP.



Baywood



Lexington



Manor



Shaker



Windsor



Seville



Oxford



Liberty



Pioneer



Pioneer  
Cathedral



Legend



Regency



Cambridge



Dunnhill

# LAMI Base Cabinet Features

## DRAWERS:

Drawer boxes are 12mm plywood construction  
Matching 1/4" plywood bottom  
Four-sided construction

## BRACES:

Corner gussets provide anchor points for counter tops

## BACK:

1/4" exterior grade 7-ply hardwood plywood with light maple vinyl glued and mechanically fastened to rabbet in ends

## DRAWER SLIDES:

Side mounted, 75 lb-rated metal slides

## SHELVES:

Half-depth fixed shelf is constructed of 12mm exterior grade 7-ply hardwood plywood with light maple vinyl

## HINGES:

Concealed Hinges

## END PANELS:

12mm exterior grade 7-ply hardwood plywood with light maple vinyl interior

## TOE KICKS:

1" x 6" construction with ACQ pressure treated southern yellow pine, full height toe kick attached to all surfaces for toughest environments

## BOTTOMS:

12mm exterior grade 7-ply hardwood plywood with light maple vinyl. Bottoms are glued into dados all four sides

## FRAMES:

3/4" thick and 1-3/4" wide kiln-dried hardwood assembled under pressure with screws

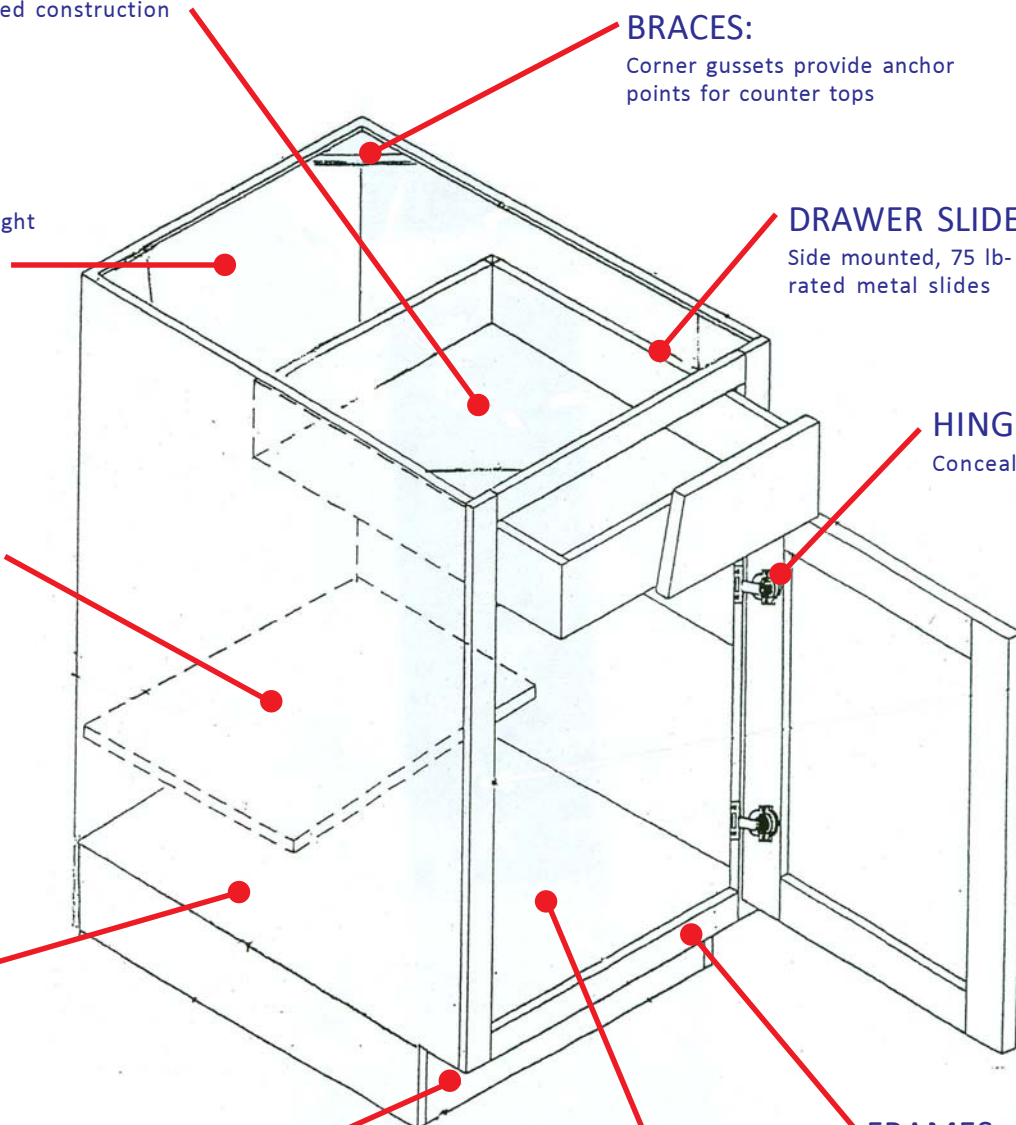

# LAMI Wall Cabinet Features

---

## BACK:

1/4" exterior grade 7-ply hardwood plywood with light maple vinyl glued and mechanically fastened to rabbet in ends

## FRAMES:

3/4" thick and 1-3/4" wide kiln-dried hardwood assembled under pressure with screws

## HINGES:

Concealed Hinges

## END PANELS:

12mm exterior grade 7-ply hardwood plywood with light maple vinyl interior

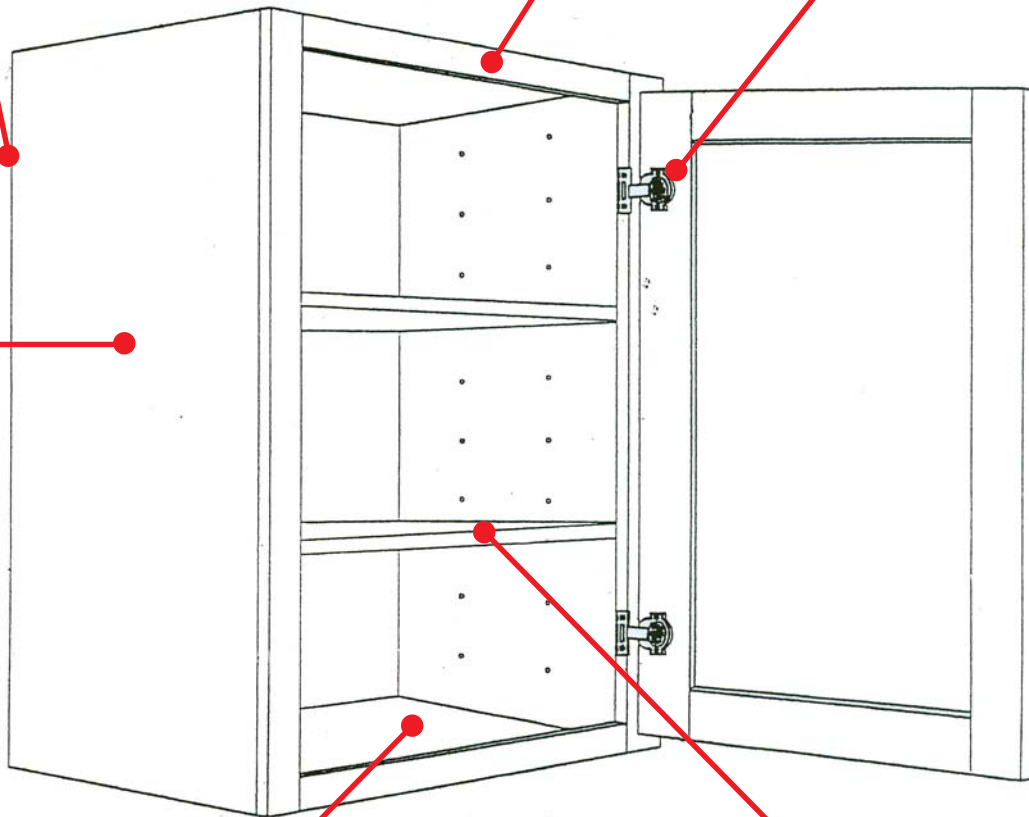

## TOPS & BOTTOMS:

12mm exterior grade 7-ply hardwood plywood with light maple vinyl. Bottoms are glued into dados all four sides

## SHELVES:

Half-depth fixed shelf is constructed of 12mm exterior grade 7-ply hardwood plywood with light maple vinyl

---

# LAMI Severe Use Standards

---

- Wall and base backs are 1/4" exterior grade 7-ply hardwood plywood with light maple vinyl.
  - Backs are glued and mechanically fastened to rabbet in ends.
  - Base bottoms are 12mm exterior grade 7-ply hardwood plywood with light maple vinyl. Bottoms are glued into dados all four sides.
  - Wall tops and bottoms are 12mm exterior grade 7-ply hardwood plywood with light maple vinyl. Tops and bottoms are glued into dados all four sides.
  - Shelves are 12mm exterior grade 7-ply hardwood plywood with light maple vinyl and matching PVC edge banding.
  - Countertop attachment rails are 12mm exterior grade 7-ply hardwood plywood and are glued into face frame, side, and back.
  - Drawer fronts, doors, and face frames are made with American hardwood solid lumber.
  - Face frame stile and rail is dimensioned 3/4" x 1-3/4" full profile.
  - Doors are fitted with heavy duty concealed hinges.
  - Drawer boxes are 12mm plywood construction and matching 1/4" plywood bottom.
  - Drawer Slides are 75 lbs metal slides.
  - Toe kick is 1" x 6" construction with ACQ pressure treated southern yellow pine. Full height toe kick is attached to all surfaces for the toughest environments.
-